

# TVB-2G-AD TruVision Double Gang Box Adapter Plate Installation Instructions

## Description

TVB-2G-AD is an adapter plate used when attaching a fixed lens bullet camera to a double gang box or attaching a TVD-LWB-1 or TVD-LWB-2 L-shaped wall mount to a double gang electrical box. The double gang box is not included.

**Note:** When installing the TVD-LWB-1 or TVD-LWB-2 wall mount outdoors, please select a camera with an IP66 weather resistant rating. Conceal the cable harness in the double gang box.

Please refer to the installation instructions for TVD-LWB-1 and/or TVD-LWB-2 for more information.

Figure 1: Physical description

Dimensions: 110 × 110 mm (3.3 × 3.3 in.)

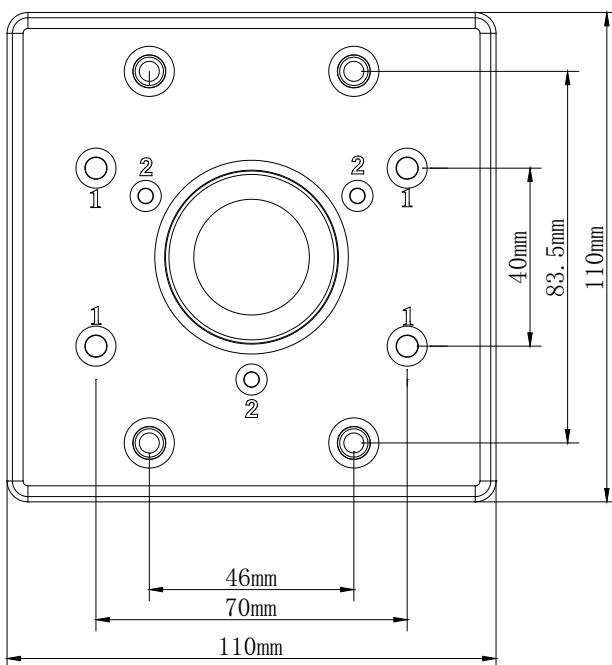

Weight: 73 g (0.16 lb.)

### Accessories:

**Screw A** M4 x 10 mm (3 pcs)  
Use for attaching the bullet camera to TVB-2G-AD adapter plate



**Screw B** M6 x 10 mm (4 pcs)  
Use to attach the TVB-2G-AD adapter plate to the double gang box.



**Screw C** M6 x 8 mm (4 pcs)  
When installing lighter fixed or VF lens domes, use this screw to attach the TVD-LWB-1 or TVD-LWB-2 to TVB-2G-AD adapter plate.



**Bolt A** M6 x 10 mm (4 pcs)  
When installing heavier motorized domes, use this bolt to attach the TVD-LWB-1 or TVD-LWB-2 L-shaped wall mount to the TVB-2G-AD adapter plate.



**Rubber plug** 4 pcs  
Use for the two upper holes on the TVB-2G-AD adapter plate.



### Supported equipment

**Hole 1 TruVision L-shape bracket:**  
TVD-LWB-1  
TVD-LWB-2

**Hole 2 TruVision fixed lens analog bullet cameras:**  
TVB-4201  
TVB-2201

**TruVision TVI fixed lens bullet cameras:**  
TVB-4401, TVB-4403  
TVB-2401, TVB-2403

**TruVision Series 1 fixed lens bullet cameras:**  
TVB-3101, TVB-3102, TVB-3103  
TVB-1101, TVB-1102, TVB-1103

**TruVision Series 3 fixed lens bullet cameras:**  
TVB-5301, TVB-5302

## Installation

Follow all local safety regulations and the wall mount and/or fixed bullet installation instructions while installing the camera and accessories.

### To attach a fixed lens bullet camera to a TVB-2G-AD adapter plate:

1. Run the cable harness through the rubber plug, which can be found on the adapter plate.

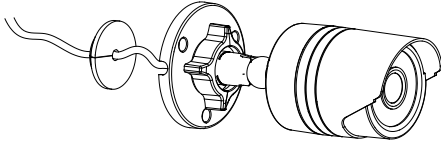

2. Insert the rubber plug in the adapter plate. Install the bullet camera on the TVB-2G-AD adapter plate using three screws (A). Reference holes labeled number 2 on the adapter plate.

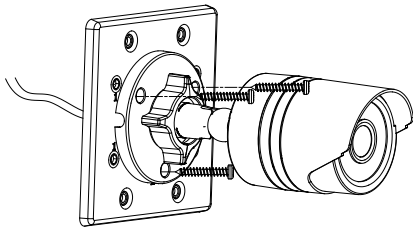

3. Make the proper connections to the camera cable harness and conceal the cables inside the double gang box. Install the adapter plate on the double gang box using four screws (B).

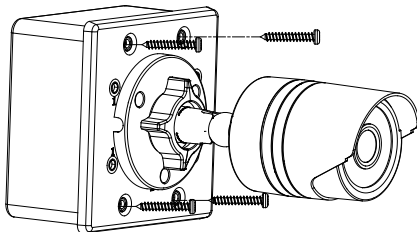

### To attach L-shape wall mount bracket to TVB-2G-AD adapter plate:

1. Follow the instructions in the camera installation manual and the TVD-LWB-1 / TVD-LWB-2 installation instructions. Mount the camera to the wall bracket.

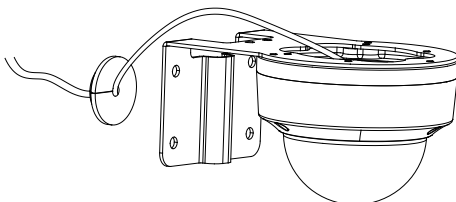

2. Run the cable harness through the rubber plug, which can be found on the adapter plate.
3. Insert the rubber plug in the adapter plate. Make the proper connections to the camera cable harness and conceal the cables inside the double gang box.

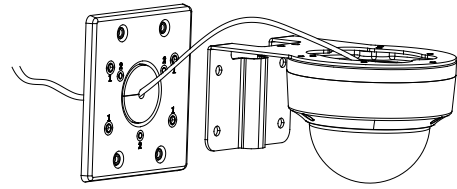

4. Install the adapter plate on the double gang box using four screws (B).

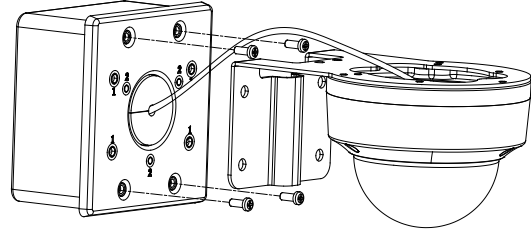

5. Attach the TVD-LWB-1 or TVD-LWB-2 wall mount (with the camera attached) to the adapter plate. If working with the lighter fixed or VF lens domes, use two of the enclosed screws (C) and two of the rubber plugs to cover the two remaining holes in the wall bracket. Reference holes labeled number 1 on the adapter plate.

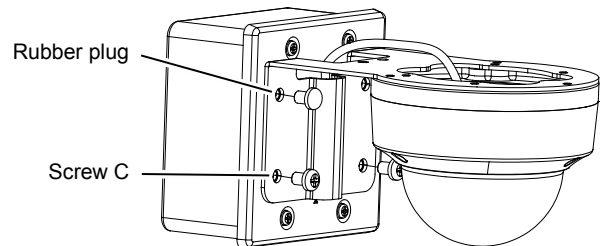

If using the TVD-LWB-2 with heavier motorized dome cameras, please install bolts (A) with a wrench. Reference holes labeled number 1 on the adapter plate.

## Legal information

<b>Manufacturer</b>	Interlogix. 2955 Red Hill Avenue, Costa Mesa, CA 92626 5923, USA Authorized EU manufacturing representative: UTC Fire & Security B.V. Kelvinstraat 7, 6003 DH Weert, The Netherlands
---------------------	---

<b>Copyright</b>	© 2016 United Technologies Corporation. Interlogix is part of UTC Climate, Controls & Security Systems, a unit of United Technologies Corporation. All rights reserved.
------------------	--

<b>Trademarks and patents</b>	The trade names used in this document may be trademarks or registered trademarks of the manufacturers or vendors of the respective products.
-------------------------------	--

## Contact information

For contact information, see [www.interlogix.com](http://www.interlogix.com) or [www.utcssecurityproducts.eu](http://www.utcssecurityproducts.eu).