

# Vertical Keypad Wall Plate Adaptor

## Description

This wall plate adaptor is designed for retrofit situations where a larger keypad was previously installed. It is compatible with the following keypads:

NX-1820E • NX-1811E • NX-1812E • NX-1815E • UM-1820E

## Installation

Observe the following guidelines when installing the wall plate:

Position the wall plate to afford the best coverage of the old mounting location.

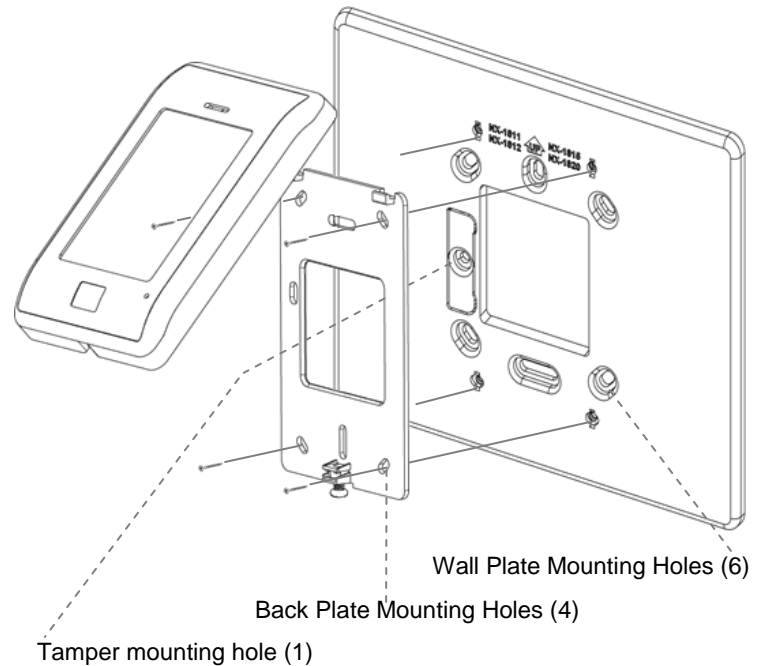

**Figure1.**  
Wall plate, with example NX-1820E back plate and NX-1820E Touch Screen

P/N 466-5230 • REV B • 21JUN16

### Installing the Wall Plate

1. Hold the wall plate against the mounting surface and mark the wall plate mounting and tamper holes. See Figure 1.
2. Insert anchors into the wall at the marked locations where studs are not present.  
Note: Wall Plate mounting hardware is not provided.
3. Mount the wall plate on the wall with screws.

### Optional Tamper Mounting

To enable the tamper function of NX-1820E, UM-1820E and NX-1815E the wall plate will require using the supplied tamper screw at the location shown in Figure 2.

Note: Tamper screw must be installed into a stud.

### Installing the Keypad

4. Secure the keypad back plate to the wall plate with the four pan head screws provided.
5. Attach the keypad to the back plate following the instructions for your keypad

**Figure 2. Tamper Mounting hole and break-away surface**

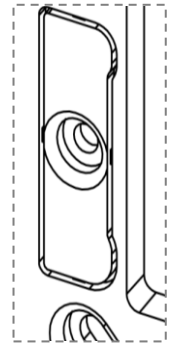

### Contact information

For contact information, visit us online at [www.interlogix.com](http://www.interlogix.com).  
For technical support, see [www.interlogix.com/support](http://www.interlogix.com/support)

### Copyright

Copyright © 2016 United Technologies Corporation. All rights reserved.

### Trademarks

Interlogix is a registered trademark of United Technologies Corporation. Interlogix is part of UTC Climate, Controls & Security, a unit of United Technologies Corporation.